

1 Bisagras

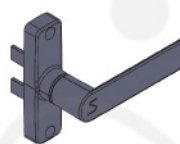

2 Falleba

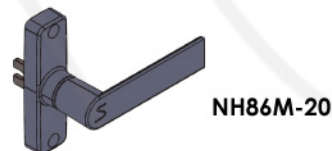

*Opcional para utilizar con conector central de NKIT000

3 Angulo de reenvío

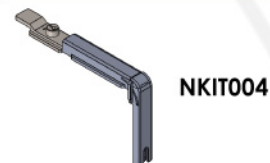

4 Punto intermedio



5 Conector



6 Puntos de cierre



7 Trabas de marco

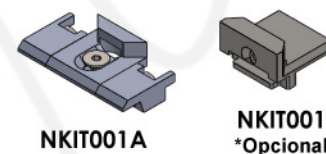

A-B-C-D-E Pletinas

- Aplicable a toda línea con Cámara Europea 15/20 y encuentro escalonado -

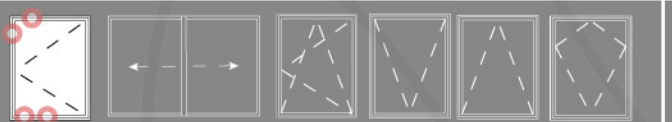

Aplicable a ventana batiente

Calado de la falleba

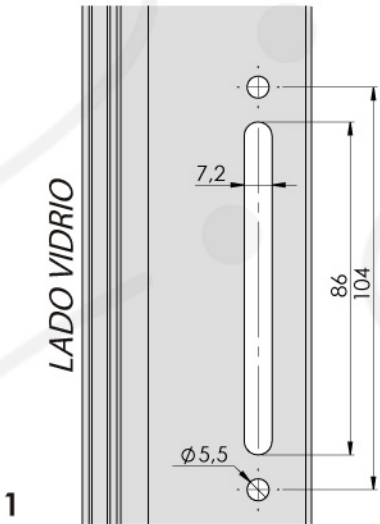

Secuencia de armado

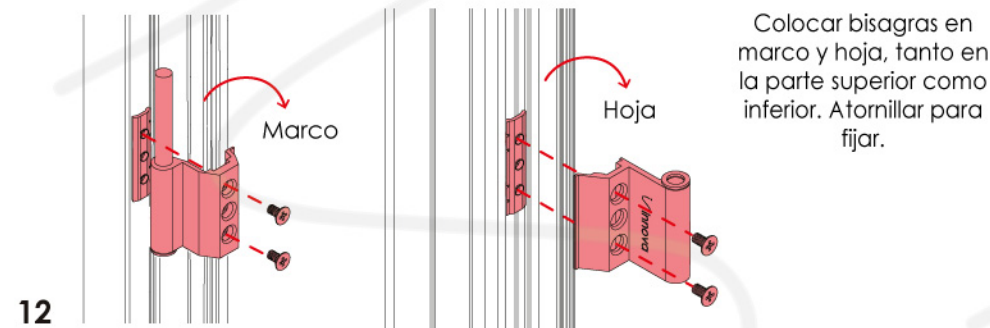
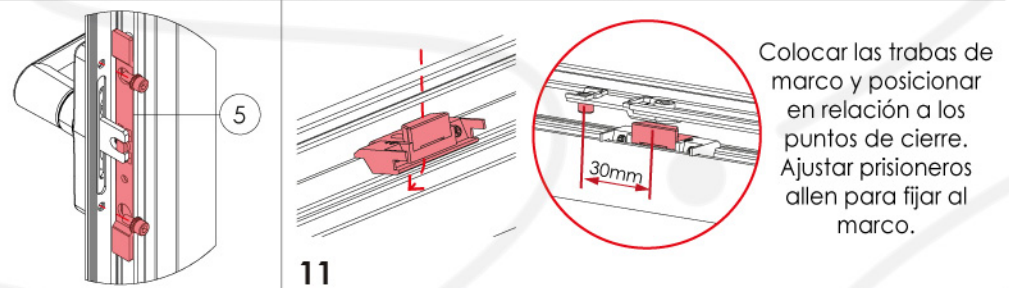
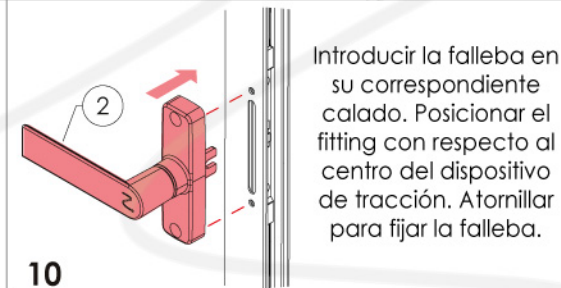
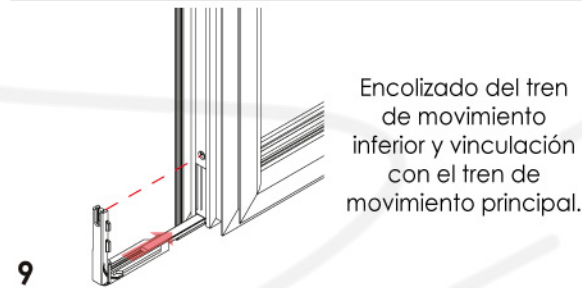
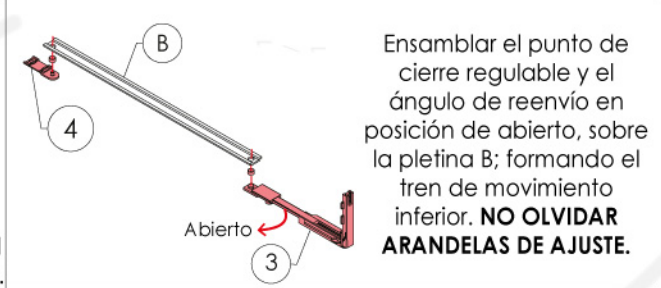
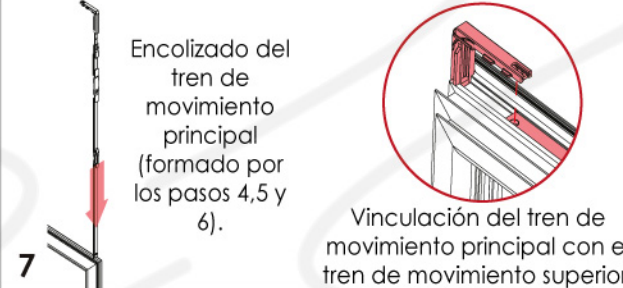
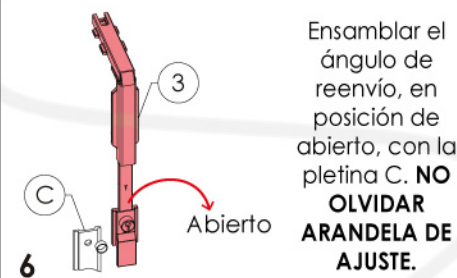
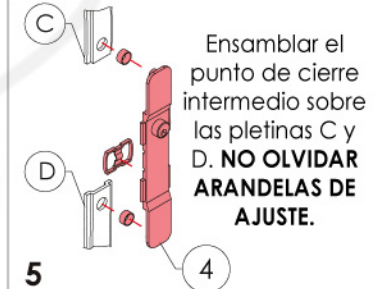
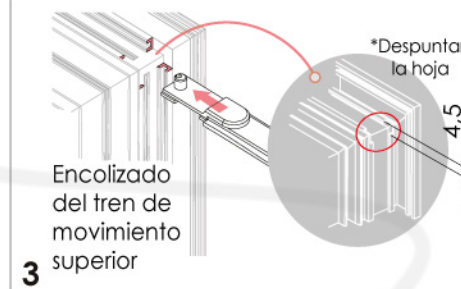
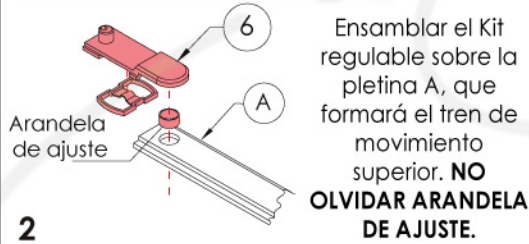

Variantes cierres multipunto

